

POTIUS™ PANEL FBB60 SERIES

FLOOR PANEL
FBB 20060 -
FBB 61060



- 25mm Plywood Flooring
- 45mm LVL web (depth varies - refer span tables)
- 45mm LVL bottom skin
- Nail-LAM connection
- Additional fixings/blocking/lining may be required for continuity of bracing, hold downs, diaphragm actions, fire corking etc

Web Depth (mm)	200	240	300	400	460	610
Maximum Span (m)	5.1	5.6	6.3	7.4	8.0	9.5
Self Weight (kPa)	0.34	0.35	0.38	0.42	0.44	0.50
Reaction at support ULS (kN/web)	8.3	9.2	10.4	12.4	13.5	16.2

Dead Load Self weight plus 0.5kPa superimposed load

Live Load 3.0kPa

Fire Rating 60/60/60

Intumescent paint to exposed LVL surfaces, fire stopping and infill required

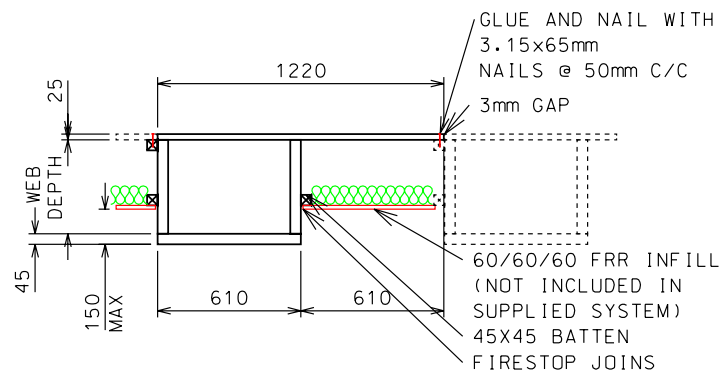

TYPICAL PANEL SECTION
SCALE 1:20

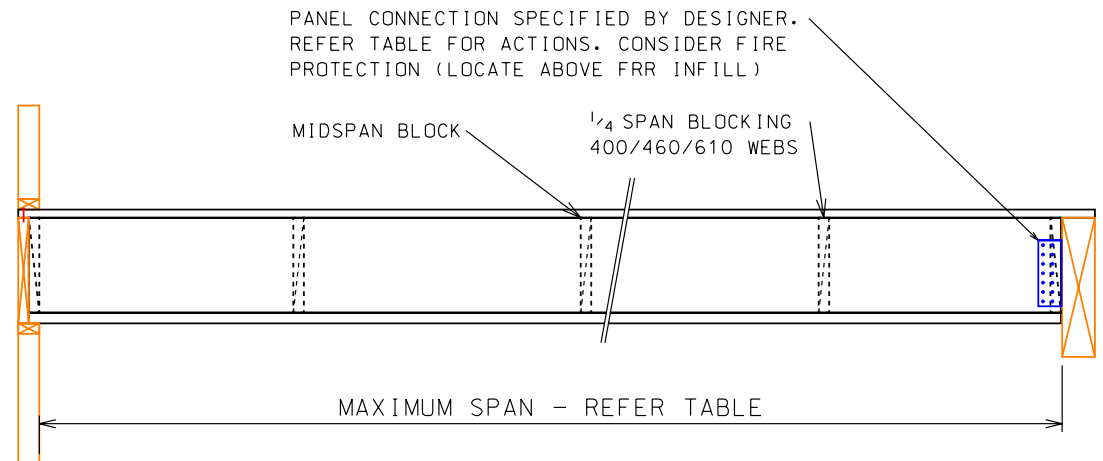

PANEL LONG SECTION
SCALE 1:20